

ST-10 WALL MOUNT BLUETOOTH ACCESS CONTROL MANUAL



Please read this manual before installation and keep it at a secure place

ST-10 WALL MOUNT BLUETOOTH ACCESS CONTROL MANUAL

Introduction

1. Measurements

	Model	ST-10
	Measurements	75*115*22mm
	Material	Plastic
	Weight	3kg

2. Features

- 1) Unlock with APP.
- 2) Unlock with IC Card.
- 3) Share eKeys via APP with different levels of authorization.
- 4) Unlock with passcodes of different validity period.
- 5) User can change his passcode on the keypad.
- 6) Keypad protection: Keypad is locked for 5 minutes after 5 times entry of wrong passcode.
- 7) Psuedo passcode: Key in any digits, the lock is unlocked if the last digits comprise of the real passcode.
- 8) Clear-up-passcode: When this passcode is keyed in, all codes that have been used on the lock are invalidated.
- 9) Auto-lock: Auto lock within 5 seconds of unlocking.
- 10) Real time monitoring: Administrator receives a push notification when a user unlocks with App.
- 11) Log in with a different mobile: When log in with a different mobile, the previous one logs out automatically.
- 12) Message notification: A message is pushed to the previous Administrator when the lock is reset.

3. Parameters

Communication	BLE 4.1
Compatible systems	Android 4.3/IOS7.0
Stand-by currency	≈5mA
Operating currency	≈1A
Power Supply	
Unlocking time	≈1.5 ms
Material	Plastic
Measurements	75*115*22mm
No. of dynamic passcodes	Unlimited

ST-10 WALL MOUNT BLUETOOTH ACCESS CONTROL MANUAL

No. of self-defined passcode	150
No. of IC card	150
Types of IC card	13.56MHz, M1

Installation

1. Wiring

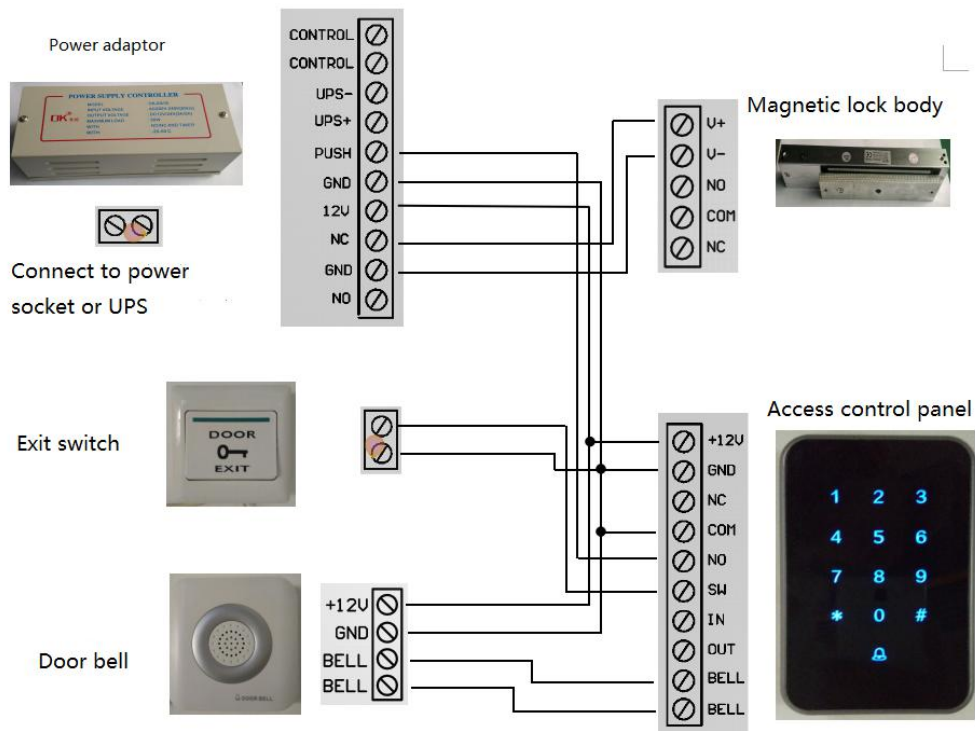

ST-10 WALL MOUNT BLUETOOTH ACCESS CONTROL MANUAL

Operation

1. Add an administrator (Pair a lock with a mobile)

- ① Power on.
- ② Activate the App, tap the head icon on the upper left screen.
- ③ Tap “Add Lock”
- ④ Tap “Door Lock”
- ⑤ Activate the keypad.
- ⑥ Tap next and follow the instructions to add the lock.

2. Send eKeys

*Only administrator and authorized users can send eKeys.

- ① Activate the App.
- ② Choose the lock of which you want to send eKeys.
- ③ Tap “Send eKey”
- ④ Key in the information and press “Send”
- ⑤ The lock will appear on the landing page of the receiver’ s App.

3. Send Passcodes

*Only administrator and authorized users can send eKeys.

- ① Activate the App.
- ② Tap the lock of which you want to send passcodes.
- ③ Tap “Send Passcode”
- ④ Choose the appropriate type of passcode you want to send.
- ⑤ Press “Generate”
- ⑥ When a passcode appears in the blank, tap the icon on the upper right of the screen.
- ⑦ Follow the instructions to send the passcode to a user.

4. Add IC cards

*only administrator and authorized users can add IC cards.

- ① Activate the App.
- ② Tap the lock on which you want to add an IC card.
- ③ Tap “IC Cards”
- ④ Tap the icon on the upper right icon and choose “Add IC Card”
- ⑤ Key in the information and press “Next”
- ⑥ Pass a card on the keypad till you hear a beap and a prompt appears on the mobile.

5. Unlock with tapping the lock icon in the App

*Mobile BLE must be on and near the access control

- ① Activate the App.
- ② Choose the lock you want to unlock.
- ③ Tap the lock icon.

6. Unlock with activating the keypad

*Mobile BLE must be on and near the access control

- ① Activate the App.
- ② Touch the keypad to activate it
- ③ The Lock is unlocked after a beep.

7. Unlock with IC cards

- ① Pass an authorized card near the keypad.
- ② The lock is unlocked after a beep.

8. Auto lock

- ① The lock is automatically locked 5 seconds after unlocking.
 - ② If the **auto lock feature*** is shut off, the lock can be locked by long pressing “#”
 - ③ Long pressing the lock icon on the App will have it locked as well.
- * Auto lock can be found in the “settings” on the App’ s landing page.

9. Delete Administrator

① When power is on, long press the reset button in the back of the access control panel, or,

② Activate the App, choose the lock you wish to delete, swap towards left (IOS) or long press (Android) and tap “Delete” when it appears.

*Above operation will reset the lock to default condition, all eKey/IC card/Passcode and other information will be permanently deleted.

10. More features

Please refer to APP manual for more detailed introduction of features.